

TRANSFORMATION OF POST-COVID WELFARE STATES IN EAST ASIA: BEYOND PRODUCTIVIST WELFARE CAPITALISM?



Date 24-25 June 2022

Venue Online (Gather Town)

Organisers  East Asian Social Policy East Asian Social Policy Research Network,



Korea Institute for Health and Social Affairs, and



Project for Advancing Human Competence
and Government Capacity

BK21 FOUR Project for Advancing Human Competence and
Government Capacity, Yonsei University

Welcoming Message



Young Jun Choi

Chair of EASP,
Professor, Department of Public Administration, Yonsei University

Colleagues, friends, welcome to the 18th EASP's annual conference with the Korea Institute for Health and Social Affairs (KIHASA) and Yonsei University.

Over the past two years, although we have all been through substantial hardship due to COVID-19, I am very happy to see so many colleagues again. There was a wish that this conference would be held face-to-face in South Korea, but the impact of COVID-19 is still in East Asia, so we meet on the metaverse.

In particular, it is an honor to hold this EASP conference jointly with the KIHASA, the best think tank in the area of politics and society in South Korea, and the Department of Public Administration BK21 Project Group at Yonsei University, which is leading the field of public administration and public policy research in East Asia. In particular, I would like to express my gratitude to President Lee, Tae Soo of KIHASA and Professor Yang, Jae-jin, who is the head of BK21 Group.

As we have all experienced, COVID-19 has impacted our lives intensely. Our freedoms have been restrained, and many have been negatively impacted on jobs and incomes. Both caregivers and recipients are at risk, and strict social distancing has exacerbated social loneliness and isolation. But, how much has our welfare state really changed? Have there been any significant and noticeable social policy changes? If not, why can't this tremendous crisis bring about great change? Why do countries respond differently and social policies produce different outcomes in different societies? Why are some countries more interested in certain policy areas and others more interested in other areas? With COVID-19, we have had more academic questions. These are the questions we want to ask during the EASP-KIHASA-Yonsei Conference.

More than 100 presentations and 300 participants, along with plenary sessions by Tae Soo Lee, Paul Pierson, Noreena Hertz, and Abe Aya, will enrich our conference. It's a pity we couldn't meet face-to-face, but we did our best to create the most comfortable metaverse for participants. We do hope that it will be an opportunity for all participants to enjoy the academic discussion and to strengthen our friendship and solidarity at the same time. We look forward to your participation in the evening reception.

This time, EASP is awarding the Post-graduate Paper Prize for the first time to the next generation of academics. Postgraduate students are important to our community. EASP will work harder to actively support students who are already conducting creative and better research. Special thanks to Professor Chikako Endo, Professor Ijin Hong, Professor Alex Jingwei He, and Professor Bingqin Li for their hard work on this.

We would also like to thank Professor Bo Young Kim, who has always played a key role in our website management and metaverse creation. Last but not least, I would like to express my gratitude to the Postgraduate students of Yonsei University, who provide a lot of support for the conference.



TRANSFORMATION OF POST-COVID WELFARE STATES IN EAST ASIA: BEYOND PRODUCTIVIST WELFARE CAPITALISM?

INDEX

| | |
|-----|---------------------------------|
| ii | Welcoming Message |
| iii | INDEX |
| 01 | Concept Note |
| 02 | Key Information |
| 03 | Program |
| 14 | Plenaries |
| 16 | Report_1st PG paper award |
| 18 | List of Participants |
| 24 | About KIHASA |
| 25 | About BK21 FOUR Project of YUPA |
| 26 | About EASP |
| 27 | User_manual |

Concept Note

More than two years after the outbreak of COVID-19, the pandemic has been bringing about fundamental changes in people's lives, employment, and the socio-economic structure. Covid-19 has produced an intensive public health crisis while social distancing and self-quarantine measures are accelerating digitalization. In the midst of COVID-19 and digitalization, individuals have experienced hardships in maintaining employment and income. Moreover, beyond these difficulties, social risks related to care and work-life balance have increased, while mental health problems from the severance of social relationships and increased isolation are becoming more serious. Further, these risks are not evenly distributed across different social classes.

East Asian countries have successfully responded to COVID-19 from a public health perspective compared to Western countries. However, the vulnerabilities and limitations of existing welfare state systems were exposed in responding to various social risks caused by COVID-19. As a result, most countries have implemented voluntary expansionary fiscal policies to maintain employment and prevent poverty in order to stabilize individuals' livelihoods and maintain growth. However, further discussion is needed as to how much these efforts stabilized individuals' lives, maintained relationships, and improved their capabilities during the last two years.

In this context, the 18th annual EASP conference will evaluate the social policy efforts of East Asian countries during COVID-19 and discuss how to restructure the welfare state. Specifically, what kinds of new 'Covid social risks' are emerging? Are they different from existing old and new social risks? What policies were introduced to respond to various 'Covid social risks', and through what politics and policy-making process were they made, and what were their results? What types of policy alternatives are being discussed and prepared to supplement or replace the existing welfare state? How are the welfare attitudes of citizens changing as they experience Covid-19? Are they moving towards pro-welfare or pro-growth?

We particularly welcome theoretical or empirical contributions exploring these questions as well as those developing new approaches to re-configure post-COVID welfare states. We also encourage contributions with a comparative and global perspective, particularly those including both East Asia and beyond. It is a long tradition of EASP to invite papers by postgraduate students and early-career researchers as well as established scholars working in the field of social welfare, social security, and social policy analysis.

Given the ongoing travel restrictions and global health concerns, we are planning to organise the conference either as an online event or a hybrid-event combining options for delegates to join keynotes and parallel sessions in a face-to-face or real-time online setting.

Key Information

This conference will be held at Gathertown Metaverse. Please follow the link below to enter the conference venue. You can access the pre-opened landing page of the place and enjoy simply OX Quiz and move around. The venue is scheduled to fully open on **June 23rd at 3 pm Seoul time.**

<https://app.gather.town/app/ahPdWBW6L1f5LkMc/EASP>

Participants are **strongly encouraged to attend our training session on June 23rd from 3 pm to 6 pm.** A staff member will be waiting for you between 3 and 6 pm. Since the metaverse is very wide, we recommend that you come and visit the place and become familiar with it. Also, for presenters, it would be appreciated if you could come to the room you present between A and H, then a staff member will help you to share the presentation slides.

Please refer to the manual at the end of this booklet for detailed instructions on using the Gathertown Metaverse.

Program Overview

(Korea Standard Time, KST, UTC+9)

| Date | Time | Schedule |
|--------------------------------|-------------|--------------------------------------|
| Day 1 24 June (Friday) | 12:30-13:00 | Venue Opening |
| | 13:00-14:00 | Welcome & Plenary Session 1 |
| | 14:00-14:10 | Break |
| | 14:10-15:50 | Paper Session 1 |
| | 15:50-16:00 | Break |
| | 16:00-17:40 | Paper Session 2 |
| | 17:40-18:40 | Plenary Session 2 |
| | 18:40-19:40 | Virtual Conference Reception |
| Day 2 25 June (Saturday) | 13:00-14:00 | Plenary Session 3 |
| | 14:00-14:10 | Break |
| | 14:10-15:50 | Papers Session 3 |
| | 15:50-16:00 | Break |
| | 16:00-17:25 | Paper Session 4 |
| | 17:25-17:35 | Break |
| | 17:35-17:45 | Post-Graduate Student Paper Award |
| | 17:45-19:00 | Plenary Session 4 & Closing Ceremony |

Plenary Sessions Room: Conference Hall

1. Welcome & Plenary Session 1 (Day 1)

Welcoming Address 13:00-13:15

Chair: Chikako Endo (Osaka University)

Professor Young Jun Choi (EASP Chair, Yonsei University)
Professor Jae-jin Yang (Professor, Yonsei University)
Professor Tae Soo Lee (President, KIHASA)

Plenary Session 1 13:15-14:00

Chair: Chikako Endo (Osaka University)

Professor Tae Soo Lee (President, KIHASA)

Challenges and Responses of the Korean Welfare State

2. Plenary Session 2 (Day 1)

Plenary Session 2 In-conversation Interview 17:40-18:40

Interviewer: Young Jun Choi (Yonsei University)

Professor Noreena Hertz (University College London)

The Lonely Century - A Call to Reconnect

3. Plenary Session 3 (Day 2)

Plenary Session 3 13:00-14:00

Chair: Shih-jiun Shi (National Taiwan University)

Professor Paul Pierson (UC Berkeley)

After Covid: Lessons from the Missed Turn in U.S. Social Policy

4. Plenary Session 4 & Closing (Day 2)

Post-graduate Paper Award 17:35-17:45

Plenary Session 4 17:45-18:45

Chair: Bingqin Li (University of New South Wales)

Professor Aya Abe (Tokyo Metropolitan University)

In Transition? Japanese Welfare State Before/After COVID-19

Closing Address 18:45-19:00

Chair: Young Jun Choi (Yonsei University)

Professor Tae Soo Lee (President, KIHASA)
Professor Young Jun Choi (EASP Chair, Yonsei University)

Paper Sessions Overview

| | A | B | C | D | E | F | G | H |
|------------------|---|--|--|---------------------------------------|---|---|-------------------------------------|---------------------------------|
| Session 1 | Social Policy Responses to the Covid-19 Crisis | Social Policy Responses to the Covid-19 Crisis | Welfare States & Welfare Regimes | Governance, Democracy & Participation | Health & Social Care | Poverty, Inequalities, & Social Inclusion | Gender, Families and Social Capital | Population & Demographic Change |
| Session 2 | Social Policy Responses to the Covid-19 Crisis | Panel Proposal 1 COVID-19 and Insecurity in Singapore | Welfare States & Welfare Regimes | Labour Markets & Employment | Health & Social Care | Poverty, Inequalities, & Social Inclusion | Ageing & Generations | - |
| Session 3 | Panel Proposal 2 Critical Human Security and Social Policy Challenges in a Post-COVID World | Migration, Social Rights & Citizenship Stratification | Gender Inequality & Work-Family Reconciliation | Labour Markets & Employment | Higher Education Graduate Outcomes in China and East Asia | Panel Proposal 3 Food and Communities in Post COVID-19 Cities | Ageing & Generations | - |
| Session 4 | Panel Proposal 4 COVID-19 Social Policy Response in East Asia: Tracking the Productivist Welfare Regime | Panel Proposal 5 Digitalisation and Social Services in Communities | Population & Demographic Change | Labour Markets & Employment | Education & Vocational Training | Alternative Social Policy | Ageing & Generations | - |

Paper Sessions 1 Friday, 24 June, 14:10-15:50

| | | |
|-------------------|--|---|
| Session 1A | Room A - Social Policy Responses to the Covid-19 Crisis | Chair : Shih-jiun Shi (National Taiwan University) |
| | The Japanese welfare state and COVID-19: A corporate-centered conservative welfare regime and path-dependent responses | Masato Shizume (Ritsumeikan University) |
| | At what cost: Examining the impact of China's Zero Covid policy on Chinese Worker's collective actions | Kejun Chen (University of California, San Diego) |
| | How Stimulus Check Affects Welfare Attitude and Willingness to Pay Tax of People under Labor Market Threat during COVID 19? | Juhyun Bae (University of Missouri) |
| Session 1B | Room B - Social Policy Responses to the Covid-19 Crisis | Chair : Jack Chan (Sun Yat-sen University) |
| | COVID-19 pandemic in Hong Kong: Culturally responsive COVID-19 practice implications for ethnic minorities | Gizem Arat (Lingnan University) & Narine Nora Kerelian (Santa Clara University) |
| | "My Radio is my Wife and my Television is my Husband": Insights from how older adults' widows in Bono region of Ghana deals with Social Isolation and Loneliness in post- COVID-19 era | Jacob Oppong Nkansah (Lingnan University) |
| Session 1C | Room C - Welfare States & Welfare Regimes | Chair : Won Sub Kim (Korea University) |
| | Revalidating forgotten concepts of the Korean welfare state: family policy as the litmus paper of productivist welfare capitalism and Confucianism | Martin Gurin (University of Kassel) |
| | Explaining the welfare development in East Asia over the past three decades with Fuzzy Sets | Nan Yang (Liaoning University) & Stefan Kühner (Lingnan University) |
| | Building a Welfare State and Policy Learning in East Asia, Bounded Learning in Korean Long-term Care Insurance | Won Sub Kim(Korea University) & Migyeong Yun(Bremen University) |
| | The Decline of Familism? Public-Private Transfer Income in Taiwan and South Korea | Fang-Yi Huang (Yuan Ze University) & Chung-Yang Yeh (Soochow University) |
| Session 1D | Room D - Governance, Democracy & Participation | Chair : Yun Young Kim (Jeonbuk National University) |
| | Does the welfare state affect different types of political participation? | SeonHoe Han & Seoeun Oh & HyeSang Noh & YoungJun Choi (Yonsei University) |
| | Empowering-governance: An Approach to Rural Infrastructure Supply | Canyi Xie & Feng Wang (Shanghai University of Finance and Economics) |
| | Recapsulating China's COVID-19 Governance Policy: A Critical Investigative Evaluation | Xiaolong Zou & Yuan Tian (Jilin University) |
| | Political Corruption and Poverty Reduction under the Constraint of Technological Advances: A Global Panel Data Assessment | Leizhen ZANG (China Agricultural University) & Bingqian ZHANG (China Agricultural University) & Feng XIONG (Chongqing University) |
| Session 1E | Room E - Health & Social Care | Chair : Jingwei Alex He (The Education University of Hong Kong) |
| | Trials for Community Care Reform in South Korea: Limited Attempt but Invaluable Experiences | Bo-Yung Kim (Yeungnam University) |
| | Health literacy and active ageing among older persons in Hong Kong: Questioning the role of social capital | Padmore Adusei Amoah (Lingnan University) |

Paper Sessions 1 Friday, 24 June, 14:10-15:50

| | | |
|-------------------|---|---|
| Session 1E | Why do mental hospitals remain in Japan?: Familism, Institutionalism, and the Residual Welfare State | Hiroshi Takebata (University of Hyogo) |
| | Longitudinal Impacts of Long-Term Care Insurance on Later-Life Health and Perceived Satisfaction: Evidence from China | Yinkai Zhang (University of Hong Kong) & Yu-Chih Chen (Washington University) & Julia Shu-Huah Wang (University of Hong Kong) |
| Session 1F | Room F - Poverty, Inequalities, & Social Inclusion | Chair : Yuko Tamiya (Kobe Gakuin University) |
| | Multidimensional Child Poverty in South Korea: Developing Measures to Assess Progress Towards the Sustainable Development Goals | Soyoon Weon (Korea Ministry of Health and Welfare) & Shailen Nandy (Cardiff University) & Marco Pomati (Cardiff University) |
| | How does a Change in the Number of Single-person Households affect Income Distribution Statistics in Korea? | Seungju Lee (Daegu University) |
| | The impact of Covid-19 on disabled people in China: A case study of people with a visual impairment | Minjie Chen (University of Nottingham) |
| | The Limited Use of ICT Solutions for Peripheral Inaccessibilities Faced by People with Disabilities in Myanmar | Dilshan Fernando (University of Guelph) |
| Session 1G | Room G - Gender, Families and Social Capital | Chair : Yasuhiro Kamimura (Nagoya University) |
| | The Moderating and Mediating Role of Psychosocial Social Capital in the Relationship Between East Asian Children's Socioeconomic Status and Subjective Well-Being: Evidence from South Korea, Taiwan, and Hong Kong | Stefan Kühner (Lingnan University) & Evelyn Addae Aboagye (Lingnan University) & Moses Adjei (Memorial University, Canada) & Maggie Ka Wai Lau (Lingnan University) |
| | Japan's administrative reform with a new agency for child-rearing families – breakthrough or paper tiger? | Mutsuko Takahashi (Keisen University) |
| | Social Capital, Resilience, and Mental Health among High School Students in China: Gender Differences during the COVID-19 Pandemic | Chaoxin Jiang (Zhejiang University) |
| | Exploring the Gender Gap in Welfare Attitudes: Occupational Skills and Perceptions of Pay Equity | In Hye Hwang (Yonsei University) & Hyunji Lim (Sogang University) & Cheol-Sung Lee (Sogang University) |
| Session 1H | Room H - Population & Demographic Change | Chair: Chikako Endo (Osaka University) |
| | Regional Population Decline and Policy Responses in Korea | Insu Chang (KIHASA) |
| | New pathways to adulthood for South Korean women: marriage behaviors of women born in 1931-1985 and policy implication | Sunyoung Choi (KIHASA) |
| | Longterm care in Korea: Current issues and strategies to improve its system | Eunha Namkung (KIHASA) |
| | Comparing the effects of different social assistance programs on mental health: Evidence from two-wave panel data in Hong Kong | Chenhong Peng & Paul Yip (University of Hong Kong) |

Paper Sessions 2 Friday, 24 June, 16: 00-17:40

| | | |
|-------------------|---|---|
| Session 2A | Room A - Social Policy Responses to the Covid-19 Crisis | Chair : Ki Tae Kim (KIHASA) |
| | Combating Rising Unemployment amidst COVID-19: A Comparative Case Study of Policy Responses in Beijing and Singapore | Chunboramy Kuch & Ruan Zhizhi & Tang Wan Xin Louise (National University of Singapore) |
| | Optimizing Strategies for Implementing Emergency Social Policy: A Mixed Study Based on the Service Delivery Capability of Temporary Assistance in Beijing | Ling Yang (Beijing Normal University) |
| | COVID-19 Social Policy Responses in East Asia – Evidence from a Model Family Approach | Julia Shu-Huah Wang (University of Hong Kong) & Aya Abe (Tokyo Metropolitan University) & Ji Young Kang (Chungnam National University) & Inhoe Ku (Seoul National University) & Irene Y.H (National University of Singapore) & Chenhong Peng (University of Hong Kong) & Xi Zhao (Renmin University of China) |
| | Reimagining social security for socially isolated individuals: Japan-UK comparisons | Kiwako Endo (Kinjo Gakuin University) & Sachiko Horiguchi (Temple University, Japan Campus) & Teppei Sekimizu (Rissho University) |
| Session 2B | Room B - Panel Proposal 1 COVID-19 and Insecurity in Singapore | Chair : Tao Liu (Zhejiang University) |
| | Impact of COVID-19 on Low-income Families in Singapore | Ma Agnes ALCANTARA PACULDAR (National University of Singapore) |
| | Transnational Housing Insecurity: Mobility, Homelessness, and the COVID-19 Pandemic | Jeyda Simren SEKHON ATAC (National University of Singapore) |
| | Fiscal measures during crises in Hong Kong and Singapore | Yee Lok WONG & Kok-Hoe NG & Alfred M. WU (National University of Singapore) |
| Session 2C | Room C - Welfare States & Welfare Regimes | Chair : Yu Guo (Renmin University) |
| | Who Gets What and How Much? China's subnational variation of social safety net under diverse family profiles | Xi Zhao (Renmin University of China) & Julia Shu-Huah Wang (University of Hong Kong) & Qin Gao (Columbia University) |
| | Expanding social protection cover in developing East Asian countries | Mel Cousins (Trinity College, Dublin) |
| | Killing two birds with one stone? The political economy of public pension reform in Korea | Jong-sung You (Gacheon University) |

Paper Sessions 2 Friday, 24 June, 16: 00-17:40

| | | |
|-------------------|--|---|
| Sessio 2D | Room D - Labour Markets & Employment | Chair : Misa Izuwara (Bristol University) |
| | The Impact of Multimorbidity on Labour Participation for Middle-Aged and Older Adults in China | Zhang Zhang (University of North Carolina) & Bo Hu (University of London) & Sean Y. Sylvia (University of North Carolina) |
| | The locational choices of poverty-relief labour force in rural China: patterns, influence factors and policy response. | Lin Shuyi (Renmin University) |
| | Working Environment and Employment Choices of Mothers | Tomoe Naito (Seikei University) |
| Session 2E | Room E - Health & Social Care | Chair : Se Kyung Park (KIHASA) |
| | Changing Social Welfare Planning and Administration in the Local Governments under Creeping Performance Management in Japan | Koichi Hiraoka (Tokyo Online University) |
| | Political regulation , institutional effectiveness and the differences of healthcare service performance: Empirical evidence from provincial panel data in China (2004-2020) | Guohuang CAO & Ijin HONG (Sun Yat-sen University) |
| | Depicting the dynamics of healthcare systems: the trajectory equifinality model in health policy research | Ryozo Matsuda (Ritsumeikan University) |
| | The mounting tension between managerialism and reflective social work practices: A critical study of Taiwan's Social Safety Network Project | Yei-Whei Lin (National Chengchi University) |
| Session 2F | Room F - Poverty, Inequalities, & Social Inclusion | Chair : Jong Hoon Kim (KIHASA) |
| | Internal fiscal constraints, top-down pressure or horizontal competition? Local integration of urban-rural social-assistance programmes in China | Chenhong Peng & Julia Shu-Huah Wang (University of Hong Kong) |
| | The Precarities of Double Poverty - Income and Time Poverty in Post-industrial South Korea | Tae-hwan Kim & Sophia Seung-yoon Lee (Chung-Ang University) |
| | To Sue or Not to Sue? The Dilemma of Family Maintenance Litigation Caused by the Social Assistance System in Taiwan | Li-Yun Ko (Social Affairs Bureau of Kaohsiung City Government, Taiwan) & Pei-Yuen Tsai (National Chengchi University) |
| | Economic Inequality, Mass-Elite Communication, and Political Polarization in South Korea | Eunyoung Ha (Yonsei University) |
| Session 2G | Room G - Ageing & Generations | Chair : Young Jun Choi (Yonsei University) |
| | Analysis of Active Aging Index within Different Welfare Regimes: A Comparative study among Sweden, Italy, South Korea and China | Lili Shang (University of Melbourne) |
| | Age-Friendly City Agenda: A Strategy to Promote Productive Ageing and Ageing in Place? | Sari Handayani (Lingnan University) |
| | Two levels of agency: the negotiation of intergenerational support arrangement in Chinese families. | Jiaxin Liu (University of York) |
| | The global paradigm shift towards active ageing and beyond: an analysis of policy documents by international organisations | Kaitlyn Juryung Cho (University of Oxford) |

Paper Sessions 3 Saturday 25th June, 14:10-15:50

| | | |
|-------------------|--|--|
| Session 3A | Room A - Panel Proposal 2 Critical Human Security and Social Policy Challenges in a Post-COVID World | Chair : Jae Jin Yang (Yonsei University) |
| | Origins, Debates and Development of Critical Human Security as a Conceptual and Comparative Analytical Framework | Patricia Kennett (University of Bristol) & Huck-ju Kwon (Seoul National University) |
| | Human Security and the Public Healthcare Systems in Indonesia and the Philippines: Policy Responses to the COVID-Pandemic | Huck-ju Kwon & YeEun Ha & Kyungchul Yang & Seongyeon Park & Sodam Yi (Seoul National University) |
| | Policy, Politics and Critical Human Security in a post-Covid World: A European Perspective | Patricia Kennett & Matthew Lariviere & Noemi Lendvai Bainton & Julia Gumy (University of Bristol) |
| | Crisis Management System and Covid Pandemic in Korea: Civic participation in risk governance | Eunju Kim (Hansung University) & Yoonkyung Oh (Korea Institute of Public Administration) |
| Session 3B | Room B - Migration, Social Rights & Citizenship Stratification | Chair : Sophia Seung-yoon Lee (Chung-Ang University) |
| | Asian International Students and Health in South Korea | YoonKyung Kwak (Korea Institute for Health and Social Affairs) |
| | Getting stuck in the host country during the COVID-19 pandemic lockdown: The limbo of migrant workers in Daegu, South Korea | Steve Kwok-Leung CHAN (Keimyung University) |
| | Socio-ecological barriers to access COVID-19 vaccination among Burmese irregular migrant workers in Thailand | Tual Sawn Khai (Lingnan University) |
| | Migrant Care Workers, Deregulation and Citizenship | Reiko Ogawa (Chiba University) |
| Session 3C | Room C - Gender Inequality & Work-Family Reconciliation | Chair : Yoon Jeong Shin (KIHASA) |
| | Gender studies about Work-Family Reconciliation in HIV-Positive Gay Men in Japan | ATOBE Chisato (Rikkyo University) & IGARASHI Mai (University of Niigata Prefecture) |
| | Life-mix and the COVID Pandemic: meeting the challenges of changes in people's working and caring life | Ruby C M Chau (University of Nottingham) & Sam W K Yu (Hong Kong Baptist University) |
| | Who champions women's rights and interests in the legislature? Evidence from 21st century South Korea | Sunwoo Ryu (University of Oxford) & Mihyang Choi (Korea National Council on Social Welfare) |
| | Gendered Responsibility of Multigenerational Care: Examining 'Defamilialisation' Policies in Family Centred Welfare Regimes | Junko Yamashita (University of Bristol) & Naoko Soma (Yokohama National University) |
| Session 3D | Room D - Labour Markets & Employment | Chair : Young Jun Choi (Yonsei University) |
| | Impact of COVID-19 on Employment and Family Life of Child-Raising Generations | Yukari ITO (Osaka University) & Noriko YAMANO (Osaka Metropolitan University) |
| | The Determinants of Turnover Intention among Social Workers in Taiwan: Do Public Service Motivation and Working Conditions Matter? | Chung-Yang Yeh (Soochow University) & Helen K. Liu (National Taiwan University) & Yeun-Wen Ku (National Taiwan University) |
| | For a more sustainable social care service: occupational hazard of the social service workers and its impact on their subjective job security in South Korea | Koeun Park (Health Insurance Research Institute, South Korea) & Hyojin Seo (KU Leuven) |
| | Working precariously within the neoliberal social welfare system in Japan: Findings from the qualitative research with municipal office workers during the COVID-19 pandemic | Viveka Ichikawa & Izumi Niki & Izumi Sakamoto (University of Toronto) |

Paper Sessions 3 Saturday 25th June, 14:10-15:50

| | | |
|-------------------|---|---|
| Session 3E | Room E - Higher Education Graduate Outcomes in China and East Asia | Chair : Chikako Endo (Osaka University) |
| | The Broken Promise of Human Capital Theory: Social Embeddedness, Graduate Entrepreneurs, and Youth Employment in China | Yuyang Kang & Ka Ho Mok (Lingnan University) |
| | Massification and Privatisation of Higher Education in East Asia: Critical Reflections on Graduate Employment from the Sociological and Political Economic Perspectives | Guoguo Ke & Zhen Tian (Lingnan University) |
| | Employability and Employment Choice of Chinese Higher Education Graduates: A Perspective of Uncertain Futures | Weiyang Xiong (Lingnan University) & Youliang Zhang (Lingnan University & Beijing University of Technology) |
| | Where do China's Top University Graduates Go: Trends and Implications | Kai Zhao & Ka Ho Mok (Lingnan University) |
| Session 3F | Room F - Panel Proposal 5 Digitalisation and Social Services in Communities | Chair : Peiyuen Tsai (National Chengchi University) |
| | Digitalization, Citizenship and Evolving Welfare Regimes; The emergence of 'digital citizenship'? | Ilan Katz (University of New South Wales) & Johan Nordenthaard (University of Linköping) |
| | Bridging the digital divide for older adults in health services: Chinese Elder Peoples' Perceptions of E-Health Services | Genghua Huang (Lingnan University) & Ka Ho Mok (Lingnan University) & Yin Ma (Lanzhou University) |
| | Digitalisation and urban community food security in China | Bingqin Li (University of New South Wales) & Jiwei Qian (Singapore National University) & Juan Xu (Huazhong Science and Technology) |
| | Public Service Resilience on the Cloud: State Mobilization and Digital Self-governance in China's COVID-19 Response | Xin Han (University of Pittsburgh) |
| Session 3G | Room G - Ageing & Generations | Chair : Bo Yung Kim (Yeungnam University) |
| | Social survey and legal analysis of medical autonomy and adult guardianship systems in Taiwan | Chao-Yin Lin (National Taipei University) & Yu-Zu Tai (National Chengchi University) |
| | The Solution to Safeguard the Frail Elderly: A Comparative Study of the Adult Guardianship System between China and Japan | Yan Zi (Waseda University) |
| | Built Environments and depressive symptoms among community-dwelling older adults: a moderated mediation of sense of community and intergenerational relationships | Jiajia Zhou (Hong Kong Polytechnic University) |
| | What does 'wellbeing' mean in the context of unpaid care of older people and why does it matter? - Findings from a qualitative study in Wales, UK | Maria Cheshire-Allen (Swansea University) |

Paper Sessions 4 Saturday 25th June, 16: 00-17:25

| | | |
|-----------------------|--|--|
| Session 4A | Room A - Panel Proposal 4 COVID-19 Social Policy Response in East Asia: Tracking the Productivist Welfare Regime | Chair : Soo Hyun Lee (King's College London) |
| | COVID-19 Policy Responses in Hong Kong: "Big Market, Small Government, and Big Civil Society?" | Yee Lok WONG (National University of Singapore) |
| | The Continuity of Singapore's Productivist Welfare State: Evidence from the COVID-19 Pandemic | Mohnish KEDIA (National University of Singapore) |
| | COVID-19's Illusory Effect on Korea's Welfare Regime | Soyoung KIM (Nanyang Technological University) |
| Session 4B | Room B - Panel Proposal 3 Food and Communities in Post COVID-19 cities | Chair : Junko Yamashita (Bristol University) |
| | Urban Food Security during COVID-19 and the Community Response in Stockholm and Seoul | Johan Nordensvärd (Linköping University) & Younghwan Byun (Stockholm University) & Carl- Johan Sommar (Linköping University) |
| | Disrupting from the bottom: community-based food governance in London during COVID-19 | Catalina Turcu & Martina Rotolo (University College London) |
| | Collaborative governance in emergencies: community food supply in COVID-19 in Wuhan, China | Bingqin Li (University of New South Wales) & Jiwei Qian (National University of Singapore) & Juan Xu (Huazhong University of Science and Technology) & Yiran Li (University of New South Wales) |
| Session 4C | Room C - Population & Demographic Change | Chair : Ijin Hong (Sun Yat-sen University) |
| | The Internal Migration Policies and Skill Selection of Migrant Workers in China – Evidence from the 2014 Hukou Reform | Julia Shu-Huah Wang (University of Hong Kong) & Jing You (Renmin University) & Yinan Yao (University of Hong Kong) & Fengyu Wu (University of Hong Kong) & Chenhong Peng (University of Hong Kong) |
| | Fertility As Buffer? The Impact of Overtime Work on Women's Expectations of Having a Second Child in Post-One Child Policy Era Evidence from China Labour Force Dynamics Survey (CLDS2016) | Jinghui HUANG (Chinese University of Hong Kong) |
| | A study on the influencing factors of the COVID-19 pandemic on the willingness of Chinese residents to have three children | Siwen Qian & Yuting Tang & Qiu Sun & Zi Li (Chongqing Technology and Business University) |

Paper Sessions 4 Saturday 25th June, 16: 00-17:25

| | | |
|-------------------|--|---|
| Session 4D | Room D - Labour Markets & Employment | Chair : Hyeon Kyeong Kim (KIHASA) |
| | Beyond work-first activation in a productivist welfare regime? A micro-institutional approach to old-aged employment service in Hong Kong | Tat Chor AU-YEUNG (Lingnan University) & Ka Ki CHAN (Royal Holloway University of London) |
| | COVID-19 and Gig Work: Experiences of platform workers in Singapore | Ma Agnes ALCANTARA PACULDAR (National University of Singapore) |
| | Rethinking Individualised Retirement Protection in Hong Kong During Uncertain Times | Felix Sai Kit NG (Caritas Institute of Higher Education, Hong Kong) |
| Session 4E | Room E - Education & Vocational Training | Chair : Sang Hun Lim (Kyung Hee University) |
| | A critical review focusing on teaching and learning of Chinese students in British Russell Group Universities | Libby Steel (University of Nottingham) |
| | Gender disparities in skill level in Korea - Evidences from PIAAC data | Soorin Yoon(Korea Research Institute for Vocational Education and Training) |
| Session 4F | Room F - Alternative Social Policy | Chair : Stefan Kuhner (Lingnan University) |
| | Path Creation in the Study of Social Policy Change: A Potential Alternative Framework | Tauchid Komara Yuda (Lingnan University) |
| | Welfare dependency or minimum guarantee: An understanding from the coordination between Dibao and relevant social policy programs in China | Jianping Yao (North China Electric Power University) |
| | Three policy alternatives to strengthen active citizenship: Universal basic income, and universal basic services and the social economy | Young Jun Choi (Yonsei University) & Chikako Endo (Osaka University) |
| Session 4G | Room G - Ageing & Generations | Chair : Koichi Hiraoka (Tokyo Online University) |
| | Changing Family Role in Long-term Care Provision for the Aged in China: A Case Study of Guangzhou | ZHANG Jiayu (University of York) |
| | Preferences for Old-Age Care Arrangement in East Asian Familialistic Welfare State: The Examination of the Taiwanese Case | Chung-Yang Yeh & Yi-Chun Chou (Soochow University) |
| | Whose Direction? Conundrums of Implementing Consumer Direction in Home-based Care: Experiences of Older Chinese and Family Members | Jinbao Zhang (University of Hong Kong) & Julia Shu-Hua Wang (University of Hong Kong) & Wing-kit Chan (Sun Yat-Sen University) & Danhong Lan (Sun Yat-Sen University) |



Plenary Session 1: Challenges and Responses of the Korean Welfare State

Chair: Chikako Endo (Osaka University)

DAY 1 - 24 June (Fri), 13:14 – 14:00

Tae Soo Lee

Tae Soo Lee is the 25th president of the Korea Institute for Health and Social Affairs. Before joining KIHASA, he had been a professor at the department of social welfare at Catholic Kkottongnae University for 20 years. He served on the Daily Life Quarantine Committee and the Normal Life Recovery Committee during the covid-19 pandemic. He is currently a member of various government committees, including the National Pension Fund Management Committee, Social Security Committee, and Interior and Safety Ministry's Resident Welfare Service Reform Committee.

From 2018 to 2021, he served at the Sejong City Social Service Center as chairman of the board of directors. He also served as the first president of the Korea Human Resource Development Institute for Health and Welfare from 2004 to 2007.

His most recent publication is *Successful Country, Insecure People* he co-authored with professor Yoon Hong-Sik and professor Kim Jin Seok. In this rather audacious book, he questions about the path toward a new welfare state that boosts people's quality of life and safety. He has also written extensively on the welfare state, including, among others, *Outreaching Administrative and Welfare Community Center* (Seoul Institute, 2017, co-authored) and *Unequal Korea, Dreaming of a Welfare State* (Humanitas, 2015, co-authored).



Plenary Session 2: The Lonely Century – A Call to Reconnect

Interviewer: Young Jun Choi (Yonsei University)

DAY 1 - 24 June (Fri), 17:40 – 18:40

Noreena Hertz

Noreena has a PhD from Cambridge University and an MBA from the Wharton School of the University of Pennsylvania. Having spent 10 years at the University of Cambridge, in 2014 she moved to University College London where she is an Honorary Professor at the Institute for Global Prosperity. As a global economist, whose work intersects the nexus of economics, technology, politics and society – and a pioneering and renowned thinker on ESG, the post-millennial generation and community building – Noreena also advises some of the largest organizations and most senior leaders in the world on strategy and transformation. She sits on the boards of Nasdaq-listed Warner Music Group and the HR Tech Company, Workhuman. She has served on Citigroup's Politics and Economics Global Advisory Board, the Inclusive Capitalism Taskforce's Advisory Group, and RWE's Digital Transformation Board, and her thinking served as the inspiration for Bono's Product 'Red'. As a visionary thinker, Noreena is also frequently sought after as a Keynote Speaker and has given keynote speeches at TED, The World Economic Forum in Davos and Google Zeitgeist as well as for leading global corporations, sharing platforms with such luminaries as President Bill Clinton, Professor Stephen Hawking and David Beckham amongst others. Her opinion pieces have appeared in publications including The New York Times, The Washington Post, The Wall Street Journal, The Guardian, The Financial Times, Die Zeit, El Pais, and The South China Morning Post. Noreena also makes frequent television appearances around the world including on flagship television shows such as CBS' This Morning, BBC's Question Time, NHK's Global Debate. She has created and hosted four television documentaries; hosted her own show on the US' largest radio network Sirius XM, and served as the economics editor for the UK's leading commercial television network, ITV.



Plenary Session 3: After Covid: Lessons from the Missed Turn in U.S. Social Policy

Chair: Shih-jiun Shi (National Taiwan University)

DAY2 – 25 June (Sat), 13:00 – 14:00

Paul Pierson

Paul Pierson is the John Gross Professor of Political Science at the University of California at Berkeley. Pierson's teaching and research includes the fields of American politics and public policy, comparative political economy, and social theory. His most recent books are *Off-Center: The Republican Revolution and the Erosion of American Democracy* (Yale University Press 2005), co-authored by Jacob Hacker, *Politics in Time: History, Institutions and Social Analysis* (Princeton University Press 2004), and *The Transformation of American Politics: Activist Government and the Rise of Conservatism* (Princeton University Press 2007), which was co-edited with Theda Skocpol, and *Winner-Take-All Politics: How Washington Made the Rich Richer and Turned Its Back on the Middle Class* (Simon and Schuster 2010), also co-authored by Jacob Hacker. Pierson is an active commentator on public affairs, whose writings have recently appeared in such outlets as *The New York Times Magazine*, *The Washington Post*, and *The New Republic*. He has served on the editorial boards of *The American Political Science Review*, *Perspectives on Politics*, and *The Annual Review of Political Science*. From 2007 to 2010 he served as Chair of the Berkeley political science department.



Plenary Session 4: In Transition? Japanese Welfare State Before/After COVID-19

Chair: Bingqin Li (University of New South Wales)

DAY2 – 25 June (Sat), 17:45 – 18:45

Aya Abe

Aya Abe is Professor of Social Welfare at Tokyo Metropolitan University and director of the Research Center for Child and Adolescent Poverty, Tokyo Metropolitan University. The center is the only research center in Japan focusing on poverty. Her research focuses on child poverty, social inequality and social policy. She has published numerous books and articles, of which the most famous is *Kodomo no hinkon—Kaiketsu-saku o kangaeru* (Child Poverty: Thinking about Solutions, 2014), *Kodomo no hinkon—Nihon no fukōhei o kangaeru* (Child Poverty: Rethinking Fairness in Japan, 2008). Professor Abe has served on numerous government committees on social policy and currently serves as a committee member in the Public Assistance Division of the Social Security Council in the Ministry of Health, Labor and Welfare.

Report for 1st EASP Paper Prize

A total of 14 papers were received for the 1st EASP Postgraduate award. The papers were reviewed by a judging panel made up of EASP committee members. The papers were reviewed according to the criteria of originality, analytical rigor, appropriate methodology and sources, clarity of writing and coherence of argument. Five papers were shortlisted. Each panel member read all short-listed papers and came to a unanimous agreement that, while each paper has their merits, **'Public Service Resilience on the Cloud: State Mobilization and Digital Self-Governance in China's COVID-19 Response'** by Xin Han (University of Pittsburgh) stands out.

The paper examines the role of online communities in collaborative governance for emergency management and public service provision. For this purpose, it examines the case of online self-governance in China during and after the COVID-19 pandemic. Through intra and inter-case comparisons of different types of digital communities, it concludes that centralized online collaboration may initially be more efficient, while decentralized collaboration is more sustainable over time due to extensive networks.

The judging panel was impressed with the paper's solid literature review which clarified the contribution of the research, the well-designed methodology involving both interview and survey data, as well as the clear writing and coherent structure of the paper. Most of all, the paper makes original contributions to the literature on collaborative and interactive governance on multiple dimensions. First, it highlights the little-understood role of emergent self-governed online communities in public service provision. Second, it empirically shows the different ways communities have participated in the production of public services even in a highly constrained physical and institutional environment. In doing so, it adds a novel dimension to existing theories of governance and gives practical implications for how to design effective and sustainable public services. What is more, it tells a compelling story of ordinary people's ability to organise and overcome difficulties in times of emergency.

Report for 1st EASP Paper Prize

This paper is awarded for its theoretically grounded novelty, thoughtful research design and analyses. In addition, crisis-management is an increasingly important topic for social policy and human well-being in today's world. We are delighted to see an early career researcher being able to produce this piece of exciting research. We hope this award will encourage more earlier career scholars to do excellent research and contribute to social policy and society.

Judging panel members: Alex Jingwei He, Bingqin Li, Ijin Hong and Chikako Endo

Short-listed papers (in alphabetical order by author's last name)

Kaitlyn Juryung Cho and Joonbeom Lee 'Personal Development and Civic Engagement of Older Adults: Impacts of Active Ageing Policies with a Focus on Socioeconomic Status'

Dilshan L. Fernando 'The Limited Use of ICT Solutions for Peripheral Inaccessibilities Faced by People with Disabilities in Myanmar'

Shian Yin 'How Do Young People Leave the Care System in China? A Scoping Review on Governmental Support for Care-experienced Youth in China'

Jinbao Zhang, Julia Shu-Hua Wang, Wing-kit Chan, Yongen Chen and Danhong Lan, 'Policy Designs and Consumer Direction in Home-based Care: Experiences of Older Chinese and Family Members'

List of Participants

| full name | Institution/ Company | Position | Corresponding Country/ Territory | Email Address |
|--------------------------|--|--|----------------------------------|--------------------------------|
| Addae Evelyn Aboagye | Lingnan university | PhD student | Hong Kong | evelynaboagyeaddae@ln.hk |
| Amoah Padmore Adusei | Lingnan University | Assistant Professor | Hong Kong | pamoah@LN.edu.hk |
| ARAT Gizem | Lingnan University | Assistant Professor | Hong Kong | gizemarat@ln.edu.hk |
| Atac Jeyda Simren Sekhon | National University of Singapore | Research Assistant | Singapore | jeyda.simren@nus.edu.sg |
| Bae Juhyun | University of Missouri | Ph.D candidate | USA | jbae@mail.missouri.edu |
| BIN ROKHIM SHAHRUDIN | National University of Singapore | Assistant Manager | Singapore | shahrudinrokhim@nus.edu.sg |
| Bingqian Zhang | CAU | PhD student | China | zhangbingqian@cau.edu.cn |
| Byun Young-hwan | SOFI, Stockholm University | Researcher | Sweden | younghwan.byun@sofi.su.se |
| CHAN Kwok-Leung Steve | Keimyung University | Assistant Professor | South Korea | sklchan@gmail.com |
| Chaoxin Jiang | Zhejiang University | Phd candidate | China | chaoxinjiang@zju.edu.cn |
| Chau Ruby | University of Nottingham | Associate Professor in Public and Social Policy | UK | ruby.chau@nottingham.ac.uk |
| Chen Kejun | University of California, San Diego | Master student | USA | kec007@ucsd.edu |
| Chen Minjie | University of Nottingham | A second-year PhD student, School of Sociology and Social Policy, University of Nottingham | China | lxmc14@nottingham.ac.uk |
| Chen Yu-Chih | The University of Hong Kong | Assistant Professor | Hong Kong | yuchih@hku.hk |
| Cheng Yuhang | Zhejiang University | Master student | China | 22022023@zju.edu.cn |
| Cheshire-Allen Maria | Swansea University | Researcher | UK | m.cheshire-allen@swansea.ac.uk |
| Chisato ATOBE | Rikkyo University | Assistant Professor | Japan | catobe@rikkyo.ac.jp |
| Cho Kaitlyn Juryung | University of Oxford | Ph.D candidate | UK | juryungcho@gmail.com |
| Choi Mihyang | Korea National Council on Social Welfare | Senior Researcher | South Korea | myang.choi@gmail.com |
| Choi Young Jun | Yonsei University | Professor | South Korea | sspyjc@yonsei.ac.kr |
| Chor AU-YEUNG Tat | Lingnan University | Assistant Professor | Hong Kong | tatchoraueyung@ln.edu.hk |
| Cousins Mel | Trinity College, Dublin | Research Fellow | Ireland | cousinsm@tcd.ie |
| Endo Chikako | Osaka University | Associate Professor | Japan | cendo@hus.osaka-u.ac.jp |
| Endo Kiwako | Kinjo Gakuin University | Assistant Professor | Japan | endo-k@kinjo-u.ac.jp |

List of Participants

| full name | Institution/ Company | Position | Corresponding Country/ Territory | Email Address |
|---------------------|--|--|----------------------------------|----------------------------------|
| Fernando Dilshan L. | University of Guelph | PhD Candidate | Canada | fernadil@uoguelph.ca |
| Guohuang Cao | Sun Yat-sen University | Ph.D candidate | China | 229490167@qq.com |
| Gurín Martin | University of Kassel | Research Assistant/doctoral researcher | Germany | martin.gurin@uni-kassel.de |
| Ha Eunyoung | Yonsei University | Research fellow | South Korea | haeunyoung16@gmail.com |
| Han Seon Hoe | Yonsei university | Master student | South Korea | shvoie018@yonsei.ac.kr |
| Han Xin | University of Pittsburgh | PhD Candidate | USA | XIH76@pitt.edu |
| Handayani Sari | Lingnan University | PhD student | Hong Kong | sarihandayani@ln.hk |
| Hiraoka Koichi | Tokyo Online University | Professor | Japan | PFE00344@nifty.ne.jp |
| Hong Ijin | Sun Yat-sen University | Associate Professor | China | ijinhong@hotmail.com |
| Horiguchi Sachiko | Temple University, Japan Campus | Professor | Japan | sachiko.horiguchi@gmail.com |
| Hu Bo | London School of Economic and Political Science | Researcher | UK | B.Hu@lse.ac.uk |
| Huang Fang-Yi | Yuan Ze University | assistant professor | Taiwan | voyage213@saturn.yzu.edu.tw |
| HUANG Genghua | Lingnan University | Research Assistant Professor | Hong Kong | genghuahuang@ln.edu.hk |
| Huang Jinghui | The Chinese University of Hong Kong | PhD Student | Hong Kong | waterstone_edu@outlook.com |
| Hwang In Hye | Yonsei University | Lecturer | South Korea | inhye.hwang@yonsei.ac.kr |
| ICHIKAWA VIVEKA | The Factor Inwentash Faculty of Social Work, University of Toronto | PhD student | Canada | viveka.ichikawa@mail.utoronto.ca |
| Igarashi Mai | University of Niigata Prefecture | Assistant Professor | Japan | igarashi@unii.ac.jp |
| ITO Yukari | Osaka University | Guest Associate Professor | Japan | yuito@osipp.osaka-u.ac.jp |
| Izuhara Misa | University of Bristol | Professor of Social Policy | UK | M.Izuhara@bristol.ac.uk |
| Jiang Chaoxin | Zhejiang University | Phd candidate | China | chaoxinjiang@zju.edu.cn |
| Jiwei QIAN | National University of Singapore | Senior Research Fellow | Singapore | jiwei.qian@nus.edu.sg |
| Kang Yuyang | Lingnan University | Research Fellow | Hong Kong | yuyangkang@ln.edu.hk |
| Kedia Mohnish | Lee Kuan Yew School of Public Policy | Doctoral Student (Year 2) | India | e0305431@u.nus.edu |
| Kennett Patricia | University of Bristol | Professor in Comparative and International Public Policy | UK | p.kennett@bristol.ac.uk |

List of Participants

| full name | Institution/ Company | Position | Corresponding Country/ Territory | Email Address |
|-----------------------|---|--|----------------------------------|---------------------------|
| Khai Tual Sawn | Lingnan University | PhD Candidate in Sociology and Social Policy | Hong Kong | khaitualsawn@ln.hk |
| Kim Bo-Yung | Yeungnam University | Professor | South Korea | boyung@yu.ac.kr |
| KIM EUNJU | HANSUNG UNIVERSITY | Assistant Professor | South Korea | eunjukim@hansung.ac.kr |
| Kim Soyoung | Nanyang Technological University | PhD Candidate | Singapore | SOYOUNG001@e.ntu.edu.sg |
| Kim Taehwan | Chung-Ang University | graduate student | South Korea | taehwan1995@naver.com |
| Kim Wonsub | Korea University | Professor | South Korea | wskim02@gmail.com |
| Ko Iiyun | Social Affairs Bureau of Kaohsiung City Government Social Assistance Division | Social Worker | Taiwan | th10245@gmail.com |
| KOLIYUN | Social Affairs Bureau of Kaohsiung City Government Social Assistance Division | Social Worker | Taiwan | th10245@gmail.com |
| Kuch Chunboramy | National University of Singapore | Student-presenter | Singapore | chunboramy.kuch@u.nus.edu |
| Kühner Stefan | Lingnan University, Department of Sociology and Social Policy | Associate Professor | Hong Kong | stefankuehner@LN.edu.hk |
| KWAK YOONKYUNG | Korea Institute for Health and Social Affairs | Assistant Research Fellow | South Korea | aliceykwak@kihasa.re.kr |
| Kwon Huck-ju | Seoul National University | Professor | South Korea | hkwon4@snu.ac.kr |
| Lee Cheol-Sung | Sogang University | Professor | South Korea | cheolsung71@gmail.com |
| Lee Seungju | Daegu University | Assistant Professor | South Korea | lustrouschris@daegu.ac.kr |
| Lee Seung-yoon Sophia | Chung-Ang University | Professor | South Korea | leesophiasy@cau.ac.kr |
| Lee Suyeon | Seoul National University | Research Fellow | South Korea | lee.suyeon@snu.ac.kr |
| Li Bingqin | UNSW | Professor | Australia | bingqin.li@unsw.edu.au |
| Li Yiran | UNSW | Research Assistant | Australia | yiran.li@unsw.edu.au |
| Li Zi | Dean of School of Public Administration, Chongqing Technology and Business University; Director of Population and Development Research Center | Chongqing, China | China | 2225177299@qq.com |
| Lin Chao-Yin | National Taipei University (Dept. of Social Work) | Professor | Taiwan | cylin@mail.ntpu.edu.tw |
| Lin Yei-Whei | National Chengchi University | Associate professor in social policy | Taiwan | linih2005@gmail.com |
| Liu Jiaxin | University of York | PhD Researcher | UK | jiaxin.liu@york.ac.uk |
| Louise Tang Wan Xin | LKYSPP, NUS | Masters student | Singapore | Louise.tang@u.nus.edu |

List of Participants

| full name | Institution/ Company | Position | Corresponding Country/ Territory | Email Address |
|-----------------------------|---|--|----------------------------------|--------------------------------|
| Lutz Ryan | University of Bristol | PhD Student/Research Associate | UK | eg21663@bristol.ac.uk |
| M. WU Alfred | Lee Kuan Yew School of Public Policy, National University of Singapore | Associate Professor | Singapore | wumuluan@gmail.com |
| Ma Ruhua | University of York | PhD student | UK | rm1972@york.ac.uk |
| Ma Yin | Lanzhou University | Research Fellow | China | mayin@lzu.edu.cn |
| Matsuda Ryoza | College of Social Sciences, Ritsumeikan University | Professor | Japan | rmatsuda@ss.ritsumeikan.ac.jp |
| MOK Ka Ho | Lingnan University | Vice-President and Chair Professor of Comparative Policy | Hong Kong | kahomok@ln.edu.hk |
| Naito Tomoe | Seikei University | Lecturer | Japan | tomoenaito@econ.seikei.ac.jp |
| NG Felix Sai Kit | Caritas Institute of Higher Education | Research Assistant Professor | Hong Kong | fng@cihe.edu.hk |
| Ng Kok-Hoe | National University of Singapore | Senior Research Fellow | Singapore | ngkokhoe@nus.edu.sg |
| Niki Izumi | University of Toronto | Ph.D. student | Canada | izumi.niki@mail.utoronto.ca |
| Nkansah Jacob Oppong | Lingnan University | Doctoral Student | Hong Kong | oppongknkansah@ln.hk |
| Noh Hyesang | Institute for Welfare State Research, Yonsei Univ. | Junior researcher | South Korea | nohhyesang@gmail.com |
| Nordensvärd Johan | Linköping University | Reader | Sweden | johan.nordensvard@liu.se |
| Ogawa Reiko | Chiba University | Professor | Japan | reiogawa2@yahoo.co.jp |
| Oh Seo Eun | Yonsei University | student(master's course) | South Korea | oseoeun537@naver.com |
| Oladosu Ayomide | Lingnan University | PhD Student | Hong Kong | ayomideoluwasoladosu@ln.hk |
| Paculdar Ma Agnes Alcantara | LKYSPP, National University of Singapore | Research Associate | Singapore | agnesmaria_paculdar@nus.edu.sg |
| Park Koeun | Health Insurance Research Institute (HIRI) | Associate Research Fellow | South Korea | lad2claire@gmail.com |
| Peng Chenhong | The University of Hong Kong | Assistant Professor | Hong Kong | chenhongpeng2014@gmail.com |
| Qian Siwen | School of Law and Sociology, Chongqing Technology and Business University; Population Development and Policy Research Center, Chongqing Technology and Business University, China | Chongqing, China | China | NinaQianSiWen@163.com |
| Rotolo Martina | University College London (UCL) | PhD Student | UK | martina.rotolo.20@ucl.ac.uk |
| Ryu Sunwoo | University of Oxford | DPhil Candidate | UK | sunwoo.ryu@wolfson.ox.ac.uk |

List of Participants

| full name | Institution/ Company | Position | Corresponding Country/ Territory | Email Address |
|---------------------|---|--------------------------------|----------------------------------|------------------------------|
| Sekimizu Teppei | Rissho University | Associate professor | Japan | jiromaru@gmail.com |
| Seo Hyojin | KU Leuven | Postdoctoral Researcher | Belgium | hyojin.seo@kuleuven.be |
| Shang Lili | The University of Melbourne | Postgraduate Student | Australia | peacefulshang0826@gmail.com |
| Shizume Masato | Ritsumeikan University, College of Social Sciences | Professor | Japan | shizu@fc.ritsumei.ac.jp |
| Shuyi Lin | Renmin University of China | PhD student | China | shuyi_lin01@163.com |
| Soma Naoko | Yokohama National University (University of Toronto) | Professor (Visiting Professor) | Japan | soma-naoko-vr@ynu.ac.jp |
| Sommar Carl-Johan | Linköping University | PhD candidate | Sweden | Carl-Johan.sommar@liu.se |
| Steel Libby | University of Nottingham | Teaching Associate | UK | Libby.steel@nottingham.ac.uk |
| Sun Qiu | School of Law and Sociology, Chongqing Technology and Business University; Population Development and Policy Research Center, Chongqing Technology and Business University, China | Chongqing, China | China | 727004040@qq.com |
| TAI YU-ZU | National Chengchi University | Professor | Taiwan | yztai@nccu.edu.tw |
| TAKAHASHI Mutsuko | Keisen University | Professor | Japan | mutoko@keisen.ac.jp |
| Takebata Hiroshi | University of Hyogo | Associate Professor | Japan | takebata@gmail.com |
| Tang Yuting | School of Law and Sociology, Chongqing Technology and Business University; Population Development and Policy Research Center, Chongqing Technology and Business University, China | Chongqing, China | China | 2021309018@email.ctbu.edu.cn |
| Tsai Pei-Yuen | Graduate Institute of Social Work, National Chengchi University | Associate professor | Taiwan | pytsai@nccu.edu.tw |
| TURCU Dr Catalina | University College London | Associate Professor | UK | catalina.turcu@ucl.ac.uk |
| Wang Feng | School of Public Economics and Administration, Shanghai University of Finance and Economics | Professor | China | fengshufe@163.com |
| Wang Julia Shu Huah | The University of Hong Kong | Assistant Professor | Hong Kong | julia.sh.wang@gmail.com |
| Weon Soyeon | Korean Ministry of Health and Welfare | Senior Deputy Director | South Korea | soyeon.weon@mail.mcgill.ca |
| WONG Yee Lok | Lee Kuan Yew School of Public Policy, NUS | Research Associate | Singapore | wongyeelok@nus.edu.sg |
| Xie Canyi | the School of Public Economics and Administration, Shanghai University of Finance and Economics | PhD Candidate | China | xie.canyi@163.sufe.edu.cn |

List of Participants

| full name | Institution/ Company | Position | Corresponding Country/ Territory | Email Address |
|---------------------|--|---|-------------------------------------|-----------------------------|
| Xiong Weiyan | Lingnan University | Research Assistant Professor | Hong Kong | weiyanyxiong@ln.edu.hk |
| YAMANO Noriko | Osaka Metropolitan University | Professor | Japan | yamano@omu.ac.jp |
| Yamashita Junko | University of Bristol | Senior Lecturer | UK | J.Yamashita@bristol.ac.uk |
| YANG LING | Beijing Normal University | Ph.D student | China | yangling@mail.bnu.edu.cn |
| Yang Nan | Liaoning University | Associate professor | China | nanyang@lnu.edu.cn |
| Yao Jianping | North China Electric Power University | Professor | China | 50701330@ncepu.edu.cn |
| Yeh Chung-Yang | Soochow University | Associate Professor | Taiwan | chungyang.yeh@gmail.com |
| Yoon Soorin | KRIVET(Korea Research Institute for Vocational Education & Training) | Director, Centre for International Cooperation | South Korea | sryoon@krivet.re.kr |
| You Jong-sung | Gachon University | Guest Professor | South Korea | jongsungyou@gmail.com |
| Youliang ZHANG | Lingnan University; Beijing University of Technology | Research Assistant Professor; Associate Professor | China | youliangzhang@ln.edu.hk |
| Yu Sam | University of Nottingham | Part-time Dissertation Supervisor | UK | wai.yu@nottingham.ac.uk |
| Yuda Tauchid Komara | Lingnan University | PhD Student | Hong Kong | tauchidkomarayuda@ln.hk |
| Zhang Jiayu | University of York | PhD Student | UK | jz2101@york.ac.uk |
| Zhang Jinbao | The University of Hong Kong | PhD candidate | Hong Kong | jinbaozh@connect.hku.hk |
| Zhang Zhang | University of North Carolina at Chapel Hill | PhD Student | USA | zhzhang@email.unc.edu |
| Zhao Kai | Lingnan University | Research Assistant Professor | Hong Kong | kaizhao2@ln.edu.hk |
| Zhao Xi | Renmin University of China | Assistant Professor | China | zhaoxi2021@ruc.edu.cn |
| Zhen TIAN | Lingnan University | PhD student | Hong Kong | zhentian@ln.hk |
| Zhizhi Ruan | National University of Singapore | Graduate Student | Singapore | e0535355@u.nus.edu |
| Zhou Jiajia | The Hong Kong Polytechnic University | PhD student | Hong Kong | 19046695r@connect.polyu.hk |
| Zi YAN | Waseda University | Researcher | Japan | sunnyswallow424@foxmail.com |
| Zou Xiaolong | School of International & Public Affairs, Jilin University | Associate Professor | China | zou_xl@jlu.edu.cn |

About KIHASA

Over the past fifty years, the Korea Institute for Health and Social Affairs has established itself as a top think tank in not just health and welfare policies, but social policy in general.

KIHASA has been ranked no.1 institute on the survey-based list of the Hankyung Business, a Korean weekly magazine of repute, in the category of political and social sciences in 2020 and for seven consecutive years from 2012 to 2018. KIHASA is built on the belief that robust research evidence will lead to better policy decisions and performance and, in turn, to improved living standards. Thus KIHASA's two-fold mission is providing empirical and analytical bases for short-to long-term policymaking and promoting the public's understanding of policy issues concerning their health and welfare.



K I H A S A
**KOREA INSTITUTE FOR
HEALTH AND SOCIAL AFFAIRS**

About BK21 FOUR Project of YUPA

BK21 FOUR Project for Advancing Human Competence and Government Capacity to Ride Out the Great Transformation is one of major education and research projects of Department of Public Administration in Yonsei University, which is supported by National Research Foundation of Korea. The vision is to train public talents with competence and advance government capacity to ride out the Great Transformation that Korean society is facing.



We have three goals for achieving the vision; ① value creation based on empirical evidence and predictions, ② problem solving for producing policy alternatives and contribution to society against the Great Transformation, and ③ sympathy and understanding of policy practices for collaborative governance. There are various programs such as Capstone Projects representing innovations in graduate education; Research Labs supporting convergence research and creating bottom-up environment; and KOICA-YONSEI Master's Degree Program in e-Government supporting international cooperation with ASEAN countries and international spreading of the results, etc.

Thus, we aim to contribute to solve social problems through practical research that strengthens the government capacity dealing with Great Transformation.

About EASP



The East Asian Social Policy (EASP) Research Network is a regional association for academics, researchers, students and practitioners of social policy in East Asia and beyond.

The EASP was established in January 2005 to facilitate research exchange and co-operation among social policy analysts and to provide a forum and network of communication for the development of social policy as a discipline in East Asia. The Network welcomes comparative and multi-disciplinary approaches to the analysis of social policy in East Asia.

The specific objectives include:

- Hosting annual conferences on selected themes
- Promoting activities related to social policy in East Asia
- Enhancing the quality of research of social policy in East Asia
- Developing theories and knowledge of social policy from an East Asian perspective
- Promoting comparative social policy within East Asia and between East Asia and other regions in the world
- Supporting the development of knowledge, skills and experiences of doctoral students and early career researchers in the region
- Promoting social policy in teaching and learning; and
- Advancing the role of research in policy making, practice and wider public debates

The EASP is an outward-facing association and seeks to develop links with other relevant national and regional associations on related disciplines in East Asia and beyond.

User Manual



Gather Town Town Map

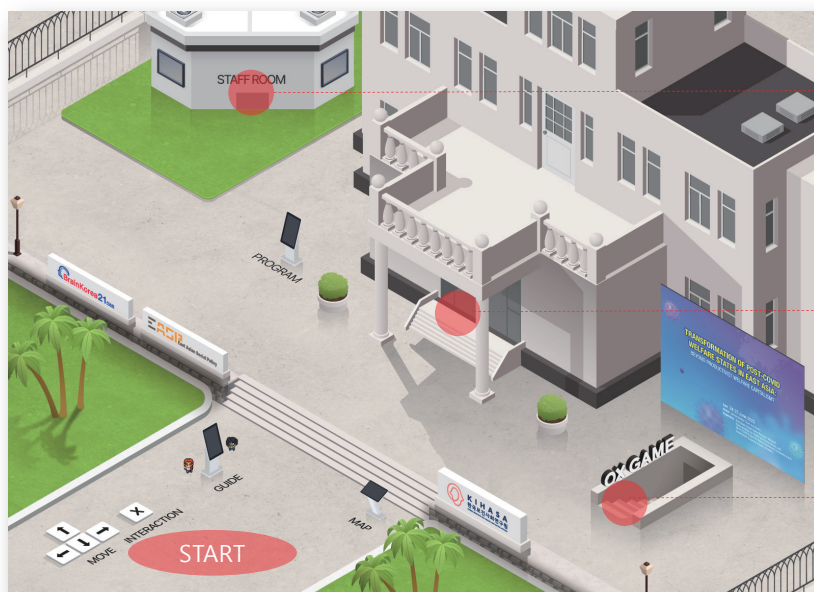

Staff Room
(Staff Only)

Main Lobby

OX Room

User Manual

Gather Town

Town Map



Gather Town

Town Map

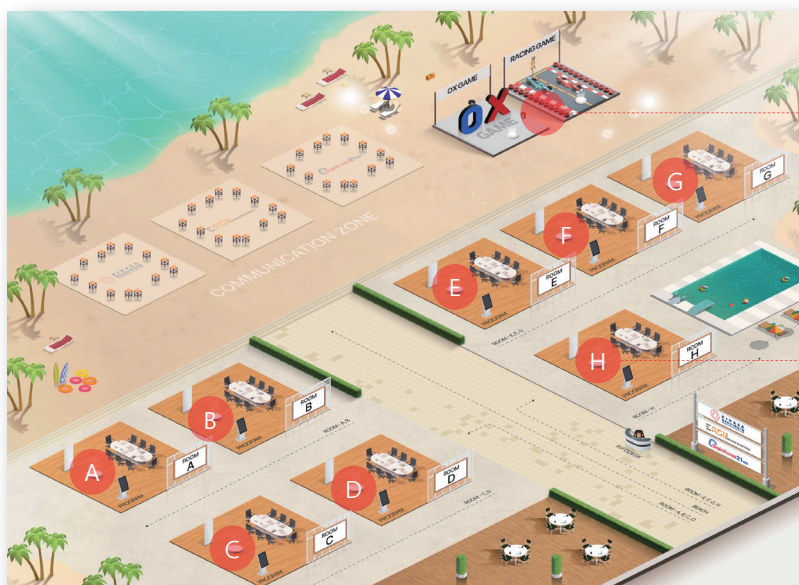

User Manual

Gather Town

Tutorial

Guideline for Presenters

1. Please arrive at the room 10 minutes before the session starts.

2. Please have a pre-meeting with the staff.
(The staff will be located in the staff seat of each stage)

3. Please choose the method of presentation.
A) The staff shares a screen.
B) Presenter directly shares a screen.

※ If you share the presentation screen directly, the slide show screen will cover the whole monitor, and if you want to switch the slide, you cannot see the Gather Town screen.
(Except when using dual monitors)

Gather Town

Tutorial

Staff shares the screen

1. Please have a pre-meeting with the staff.
(The staff will be located in the staff seat of each stage)

2. Send the presentation material to the staff.
(The Staff will let you know the email address)

3. Please say 'next please' whenever you want to switch to the next slide.

※ If you choose the method that staff shares your presentation screen, you can proceed with it in a more stable situation.

User Manual

Gather Town Tutorial

How to share presentation screen

- 1) Located avatar in the presentation seat.

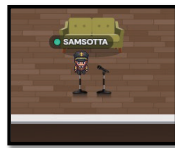

- 2) If the message below appears, spotlight has been executed..
(The message disappears after a certain amount of time since it first appeared.)

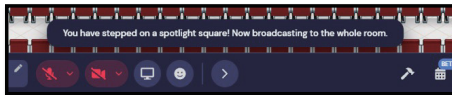

- 3) Click the 'Screen Share' icon in the lower left corner of screen.



- 3) Click the second 'Window' Tap on popup window.
- 4) Select the slideshow and click the 'Share' button.

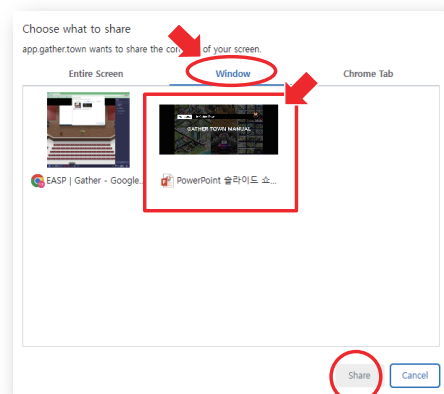

Gather Town Tutorial

Guideline for Presenters

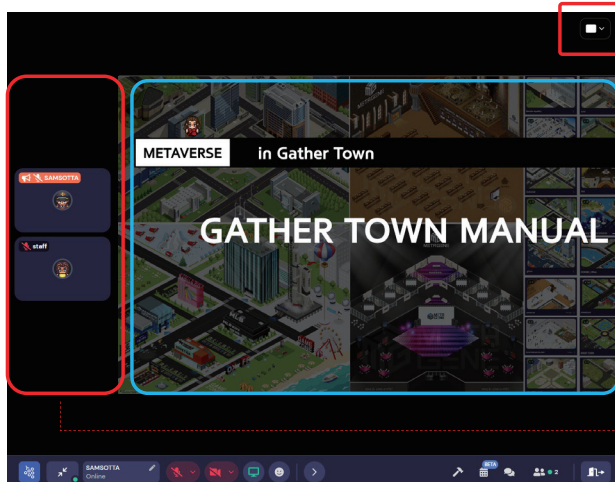

Change screen mode

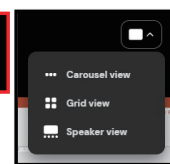

※ Try not to use it as much as possible

Screen that sharing now

Participants Camera Screen

User Manual

Gather Town Tutorial

How to play



Without installing a program,
You can enter by accessing the link through
the Chrome browser.
(Edge browser is also available, link will be notified
separately)



NO MOBILE PHONE, NO TABLET
☞ Accessible but inconvenient.
PLEASE join us with laptop or PC.



To prevent noise and echoing,
It is recommended to **wear earphones.**

1. Character setting

1) Name & Create your character

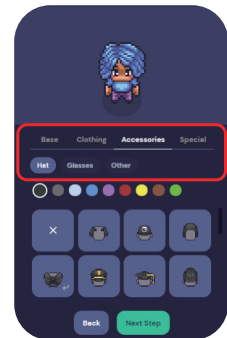
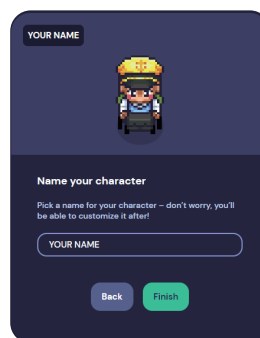

Naming your own avatar and Enter your name and decorate your
avatar to your heart's content!
Uniforming avatars with your team or colleagues or matching
colors is more fun.

Gather Town Tutorial

1. Basic Setting before get on the town

2) Camera & Speaker Setting

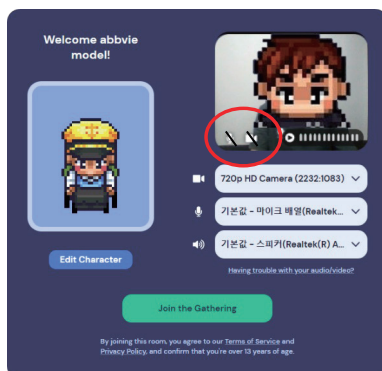

Turn **OFF**
camera &
speaker



Turn **'ON'**
Only when you
necessary

2. Basic manual After get on the town

1) How to move

Move your character with arrow keys or
'WASD' key.



2) Object Interaction

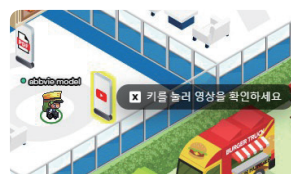

- 1) Get close to object
- 2) Yellow line will appear around the object
- 3) 'Press X button' will popup.

Z Press 'Z' key,
Your avatar will dance

G If there's a traffic jam on another avatar,
Press G key to becoming transparent and
move.

User Manual

Gather Town Tutorial

3. Screen Adjustment

Click the 'Grape shape icon' and select the 'Setting' menu.

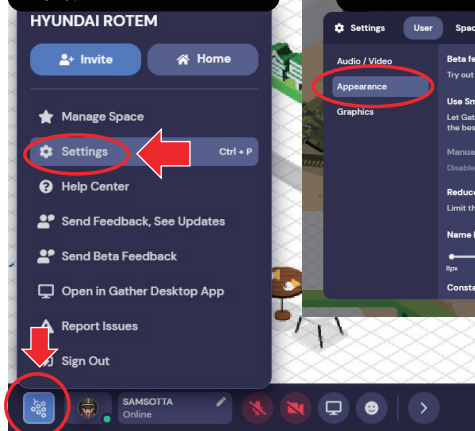

In Appearance tab, deactivate the 'Use Smart Zoom'.

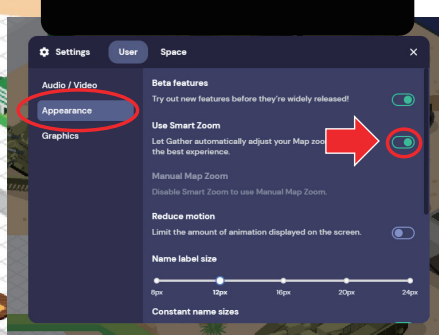

Click '100%' and join the conference with wide screen and vivid design.

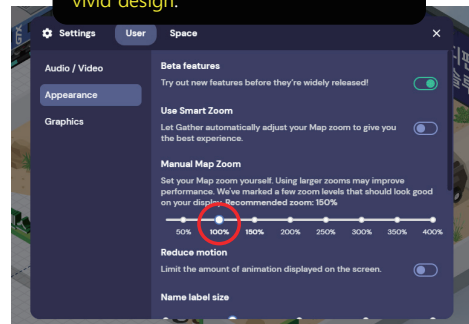

Gather Town Tutorial

4. Personal Tools Menu

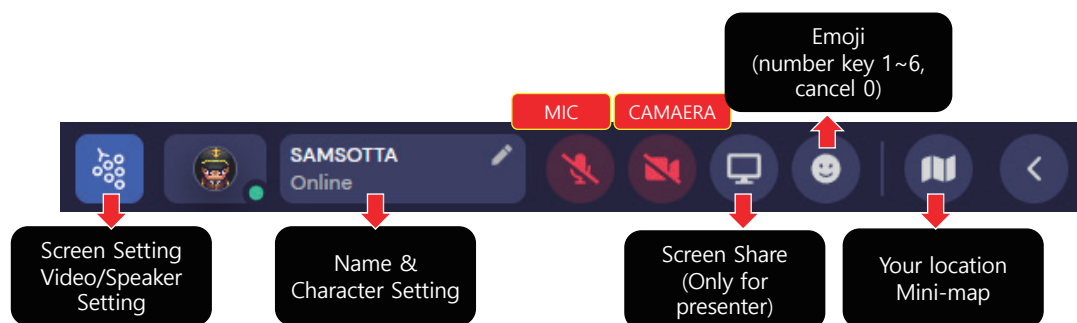

User Manual

Gather Town Tutorial

TIP) When you lost,
Move to location that you looking for

Below right side,

- ① Click the people icon - ② Click instructor/operator icon - Click Follow icon
- ※ You will automatically move to subject.

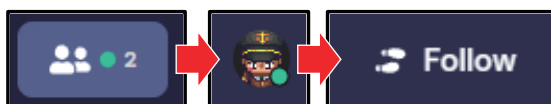

※ If you can find the character I
n the map, Right-click the
bution and follow him/her.

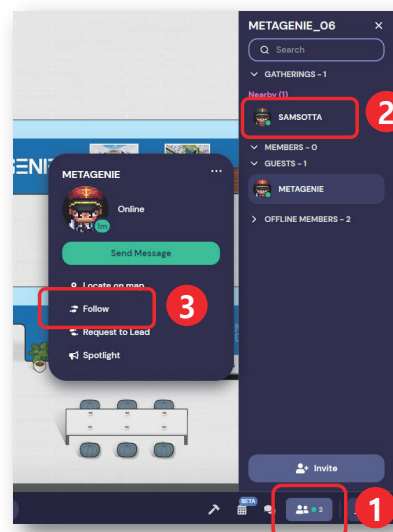
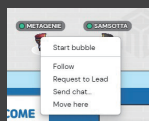

Gather Town Tutorial

TIP) When you going to specific subject

Mark the location of the subject with a guide line.
Follow the guide line.

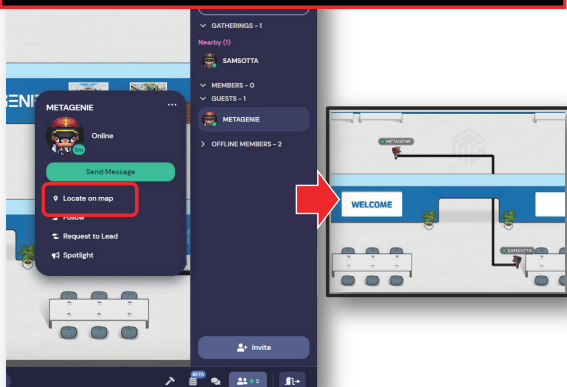

TIP) Guiding specific subject to my
location

Display the FOLLOW window on the subject.
When the specific subject clicks 'ACCEPT', it
automatically comes to you.

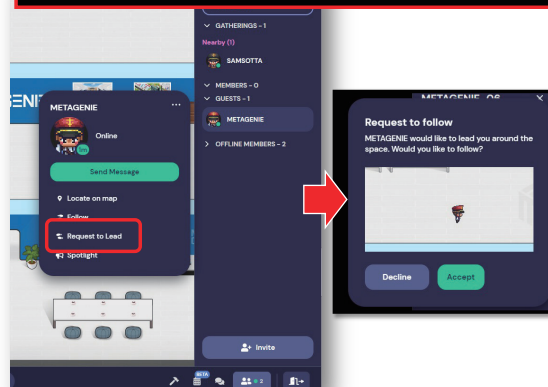

User Manual

Gather Town Tutorial

TIP) How to Chatting/Character setting change

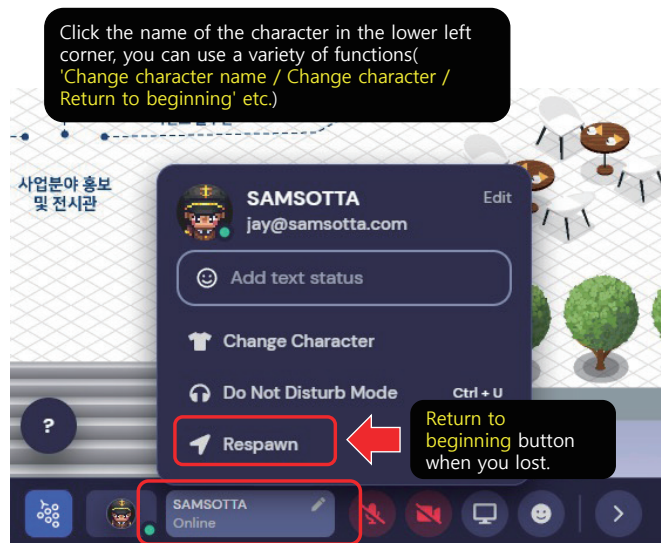
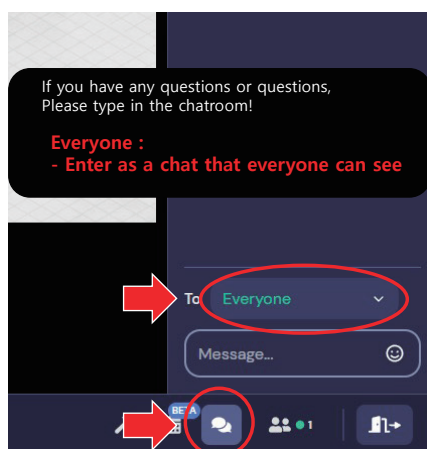

Gather Town Tutorial

TIP) 1:1 Conversation

If you need some private conversation,
Right-click the character and try 'Bubble' for 1:1
Conversation.

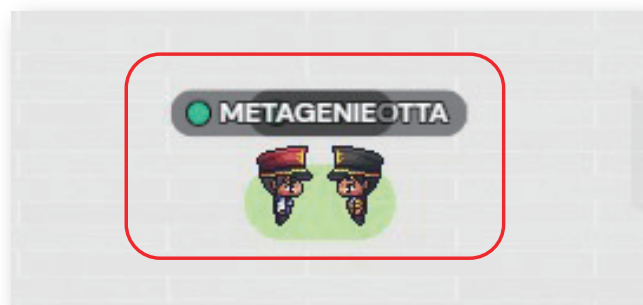
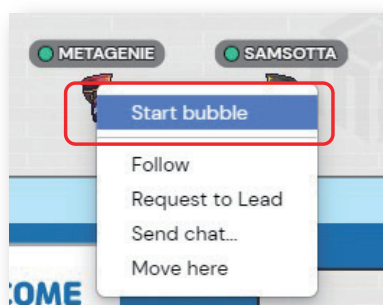

User Manual

Gather Town Tutorial

TIP) Useful function



Move to other spot
with Portal.



Press X key and check
on the yellow line.

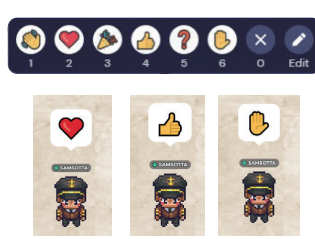

Press the number key.
Appropriate 1~4 for response
& 6 for questioning.

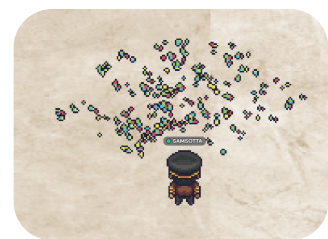

Press F key.
Pollen firecrackers are
being fired.

Gather Town Tutorial

TIP) Useful function

When you enter the private area,
1) Only that group zone looks bright.
2) Only characters in the bright area of the group zone can talk together.

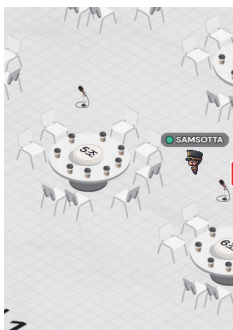

Before you are in

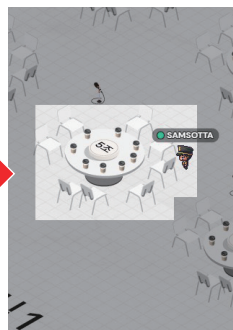

After you are in

When you get close to **microphone icon**, your sound and screen will
share with everyone.

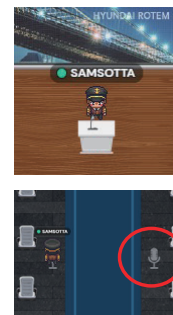

※ When presenting/questioning, click microphone shape icon. (Don't forget
to turn on the microphone function at the bottom left of the screen.)

User Manual

Gather Town

FQA

Q1 I cannot see the screen/hear sound

- 1) From the Settings menu
Choose your microphone and video as 'default'.
- 2) Please make sure you didn't leave the "Private Area".

Q2 The video screen only shows 'Connecting', but there is no sound/screen

- 1) If it is a problem with your Internet environment.
: Change Wireless to Wired or go to a place where the Internet is fast
- 2) PC specification is out of date.
: Older PCs May Cause Internet Speed Problems

※ Try refreshing (F5) and if the same symptoms continue, you can use the Internet Change and access.

Q4 I'm lost/I'm locked

- 1) Click 'Character name' in the lower left corner.
- 2) Click 'Respawn' menu (Move to Start spot)

Q3 No one else can see my chat.

- 1) The chat window is separated by 'Everyone / Nearby / 1:1'. You have to talk to "Everyone" so that everyone can see it. (Nearby: Conversation between close people or current groups)

Gather Town

If the screen is not loaded or too slow

If the screen appears black, PC specifications are often insufficient. (CPU, graphics card affected heavily)
Please adjust the options below.

※ High hardware acceleration and frame make the movement natural, but the burden on the PC increases. This is an option to lower it.

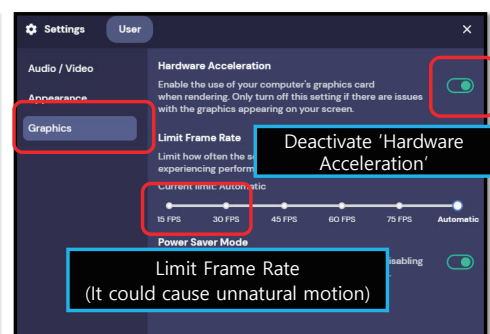
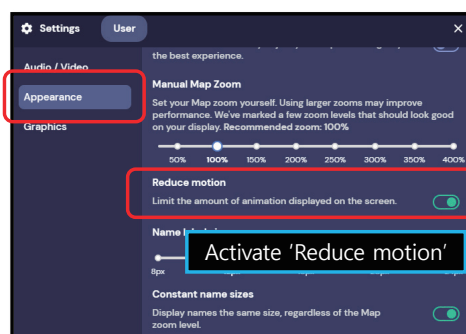
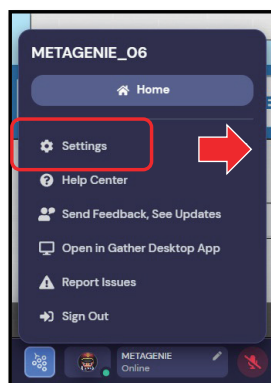

※ After setting the options, PLEASE REFRESH (press F5 key) the page.

User Manual

